

CSA 180-C / 360-C

Emulsion-splitting plant

For treatment of hydrocarbon- and color-containing waste water



Range of application:

- ❖ Oil-in-water-emulsion (e.g. wash water)
- ❖ Cooling emulsions
- ❖ Condensate
- ❖ Color- or glue-containing waste water
- ❖ Dispersion
- ❖ Rinse water
- ❖ Degreasers
- ❖ Heavy metal containing waste water

Dimensional sketch:

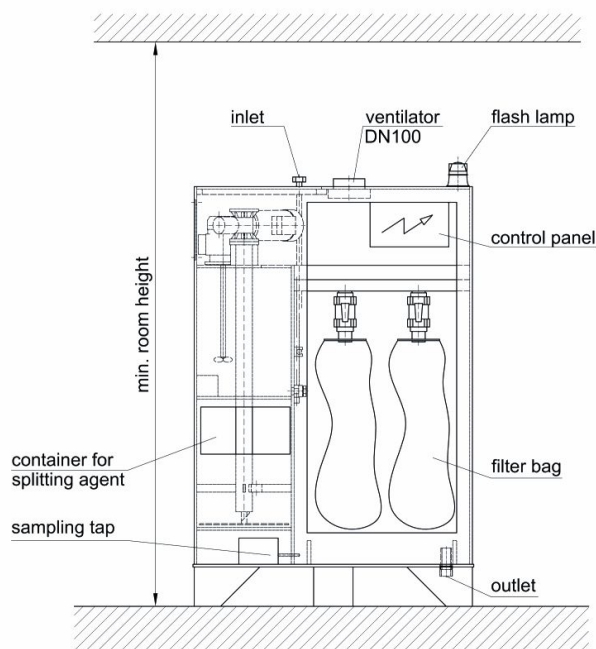

Technical information:

Type	CSA180-C	CSA360-C
Process	Continuous	Continuous
Capacity per hour	180 l/h	360 l/h
Recommended daily capacity	2 m ³	4 m ³
Power supply	230V, 50Hz, 10A	230V, 50Hz, 10A
Capacity of the reactor tanks	2 x 40 liters	2 x 80 liters
Capacity of the splitting agent tanks	30 liters	30 liters
Capacity of the filter bags	2 x 40 liters	4 x 40 liters
Empty weight	Approx. 120kg	Approx. 150kg
Operational weight	Approx. 270kg	Approx. 550kg
Waste water inlet	G 1/2"	G 1/2"
Clear water outlet	G 1 1/2"	G 1 1/2"
Dimension l x w x h mm	1070x540x1600	1195x730x1600
Min. Room height	2600mm	2600mm
Ground	Smooth + in water	Smooth + in water

Technical data subject to change



FioTec (Thailand) Co., Ltd.
 No. 320 Ekamai Soi 18
 Sukhumvit 63, Bangkok 10110, Thailand

Tel: +66-2-381-1060, Fax: +66-2-381-1061
 E-Mail: info@fiotec.com, www.fiotec.com



AWATEC AG
 Water and waste water technology
 CH-8810 Horgen, Switzerland

Tel: +41-44-727 7777, Fax: +41-44-727-7788
 E-Mail: info@awatec.ch, www.awatec.ch

CSA 180-C / 360-C

Process description:

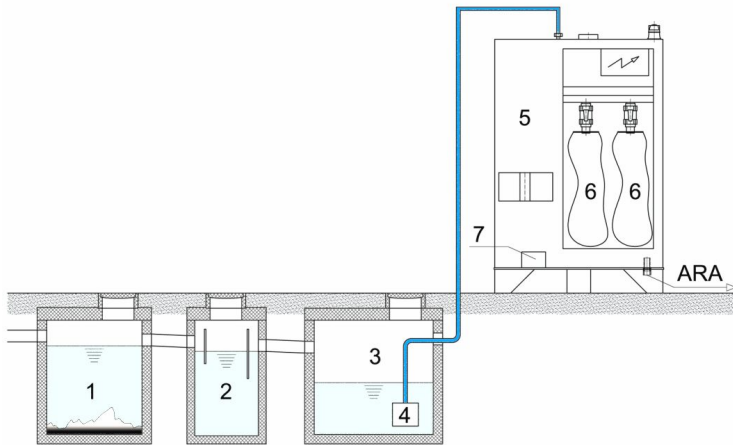

- | | |
|---------------------------|------------------|
| (1) Solid separator | (5) Reactor |
| (2) Mineral oil separator | (6) Filter bags |
| (3) Buffer tank | (7) Sampling tap |
| (4) Submersible pump | |

After pre-cleaning in the solid separator (1) and the mineral oil separator (2), the water is collected in the buffer tank (3).

The waste water is pumped into the reaction tank (5) by a level-controlled submersible pump (4). While the stirring device is running, the splitting agent is added.

Thanks to two reactors which are positioned after each other, the capacity of the splitting agent is optimally used.

The clear water is collected in the sampling basin and flows from there into the drainage.

The pollutants are eliminated and tied up in mud flakes that are held back by the filter bags (6).

Delivery:

- | | |
|---|--|
| <input checked="" type="checkbox"/> Housing complete made of PP | <input checked="" type="checkbox"/> Sensor for monitoring the splitting agent |
| <input checked="" type="checkbox"/> Float switch with automatic optical alarm | <input checked="" type="checkbox"/> Batch counter |
| <input checked="" type="checkbox"/> Filter bag set (incl. one set of spare filters) | <input checked="" type="checkbox"/> One bag splitting agent S-85-3, Color 7... |
| <input checked="" type="checkbox"/> Exhaust air fan with time control | |

Further Products of AWATEC / FioTec:

- ❖ **CSA** Emulsion splitting plants from 80 – 4000 l / h
- ❖ **COLORSPLIT** waste water purification plants for colored waste water
- ❖ **NFA** Neutralization and flocculation plants for building site waste water
- ❖ **UF/NF/RO** Ultra- and Nano filtration, Reverse Osmosis plants
- ❖ **SEP** Mineral oil separator
- ❖ **AQUAMAX, AWAREX** Biological treatment plants (SBR)
- ❖ **CSS** Specific customized large and special waste water treatment plants

Technical data subject to change



FioTec (Thailand) Co., Ltd.
No. 320 Ekamai Soi 18
Sukhumvit 63, Bangkok 10110, Thailand

Tel: +66-2-381-1060, Fax: +66-2-381-1061
E-Mail: info@fiotec.com, www.fiotec.com



AWATEC AG
Water and waste water technology
CH-8810 Horgen, Switzerland

Tel: +41-44-727 7777, Fax: +41-44-727-7788
E-Mail: info@awatec.ch, www.awatec.ch